

5 Vqc`i h`A U`ja i a`FU`h`b`f`g`f`H₅1&) š7`i`b`Ygg`c`h`Yfk`IqY`gdY`WZ`YXŁ

| DUFUa YhYf | Gna Vc` | JU`i`Y | I`b`j`h |
|--|---------|--------------|---------|
| Peak Pulse Power (8/20µs)Á | PpkÁ | 200Á | WÁ |
| Peak Pulse Current (8/20µs)Á | IppÁ | 8Á | AÁ |
| ESD per IEC 61000-4-2 (Air)Á ESD per IEC 61000-4-2 (Contact)Á | VESDÁ | ±30Á ±30Á | kVÁ |
| Operating Temperature RangeÁ | TjÁ | -55 to +125 | °CÁ |
| Storage Temperature RangeÁ | TstgÁ | -55 to +150 | °CÁ |

9`Ywf`WU`7`U`FU`W`Yf`I`q`h`W`f`H₅1&) š7`i`b`Ygg`c`h`Yfk`IqY`gdY`WZ`YXŁ

| DUFUa YhYf | Gna Vc` | A`j`b | Hnd | A`U` | I`b`j`h | HYgh7`cbX`j`h`cb |
|--------------------------|---------|-------|------|-------|---------|--|
| Reverse Working VoltageÁ | VRWMÁ | | | 12Á | VÁ | |
| Breakdown VoltageÁ | VBRÁ | 13.3Á | | 17.8Á | VÁ | IT = 1mAÁ |
| Reverse Leakage CurrentÁ | IRÁ | | | 0.2Á | µAÁ | VRWM = 12V |
| Forward VoltageÁ | VFÁ | | 1.0Á | 1.2Á | VÁ | IF = 10mAÁ |
| Clamping VoltageÁ | VCÁ | | | 19Á | VÁ | I _{PP} = 1A (8 x 20µs pulse)Á |
| Clamping VoltageÁ | VCÁ | | | 25Á | VÁ | I _{PP} = 8A (8 x 20µs pulse)Á |
| Junction CapacitanceÁ | CjÁ | | | 60Á | pFÁ | VR = 0V, f = 1MHzÁ |

Electrical Characteristics

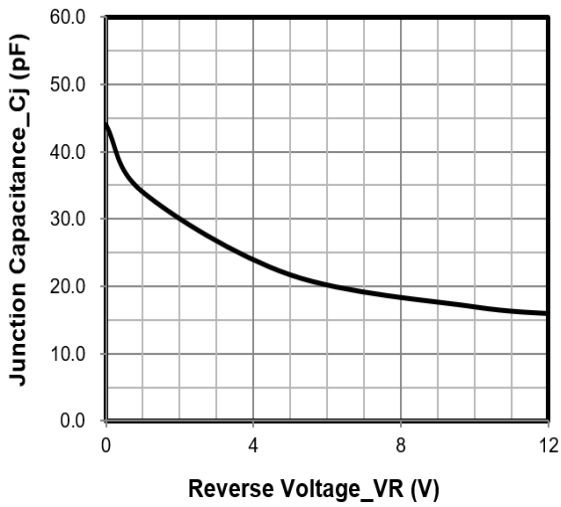

Junction Capacitance vs. Reverse Voltage

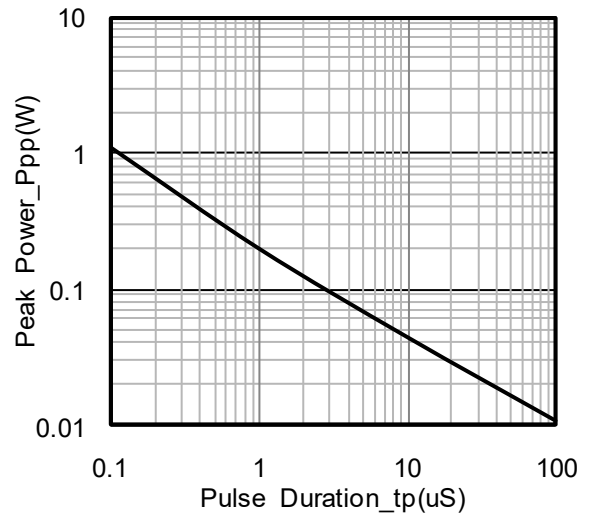

Peak Pulse Power vs. Pulse Time

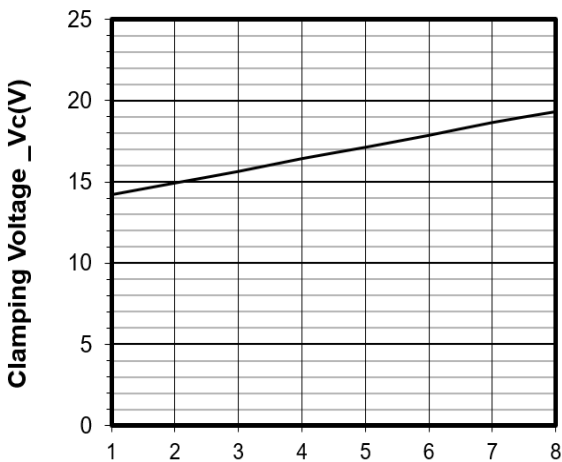

Clamping Voltage vs. Peak Pulse Current

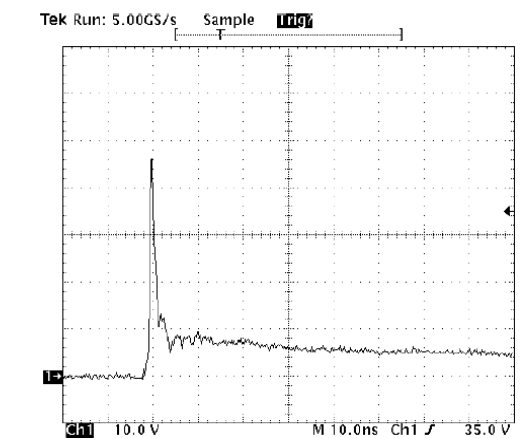
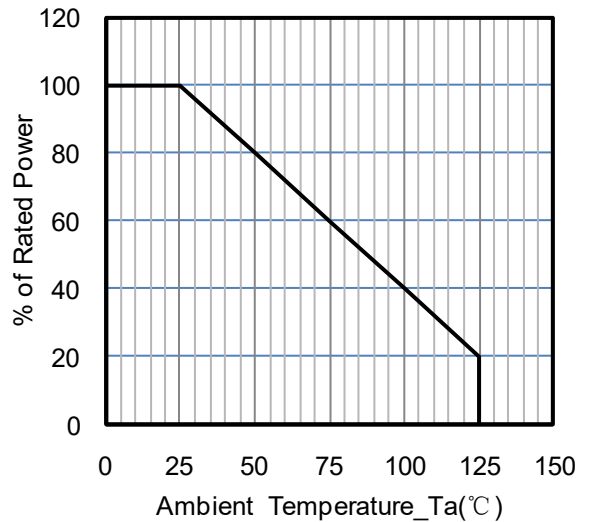

Note: Data is taken with a 10x attenuator

ESD Clamping Voltage

8 kV Contact per IEC61000-4-2

SOD-923 Package Outline Drawing

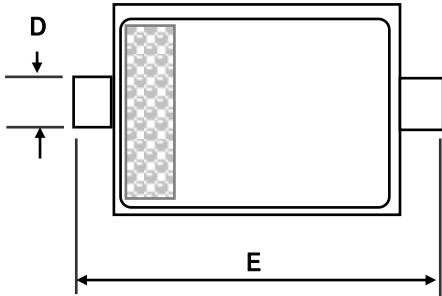
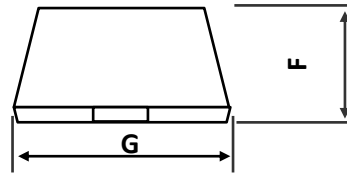
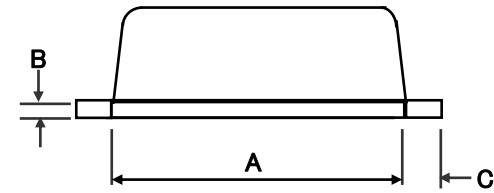

Dimensions

| Unit | A | B | C | D | E | F | G |
|------|------|------|------|------|------|------|------|
| Max. | 0.90 | 0.20 | 0.15 | 0.30 | 1.10 | 0.45 | 0.65 |
| Min. | 0.70 | 0.05 | 0.05 | 0.15 | 0.90 | 0.39 | 0.55 |

Unit: mm

SOD923 * Package Outline

Suggested Land Pattern

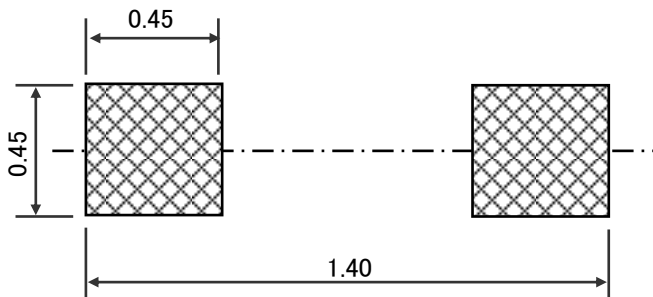

Contact Information

Changzhou D-first Electronics CO.,Ltd.

www.first-electronic.com

Email: xhf@first-electronic.cn

Phone: +86 (0519) 8817 1671